



# PLAST

## PP COMPRESSION FITTINGS AND VALVES FOR PE PIPES

ACCESORIOS DE COMPRESIÓN Y VÁLVULAS DE PP PARA TUBERÍAS DE PE

### Information / Información

PLAST are mechanical splice compression fittings. Splicing occurs through external compression of a ring at the outside wall of the polyethylene pipe. They are designed for PN10 and PN16 pressure, depending on diameter. Because they come into contact with water, PLAST fittings are compliant with applicable international standards and contain no toxic additives.

The PLAST material is manufactured in 100% PP-B, providing it with superior hydraulic and mechanical properties over other PP generations, while passing all necessary testing for use in all kinds of drinking water networks. These tests are based on international standard ISO 17885

Some examples of approved tests are (\*):

Of material / Value MRS - ISO 9080 - ISO12162 - ISO1167  
Internal pressure resistance - ISO12092  
Internal pressure with curvature - ISO3503  
Tensile strength - ISO3051  
Indoor vacuum sealing - ISO3459  
Long-term pressure test - ISO1167

(\*). You can consult our Technical Dossier where you will check the results of the tests described.

PLAST son accesorios de compresión de empalme mecánico. El empalme se realiza mediante la compresión externa de un aro a la pared externa de la tubería de PE. Están diseñados para una presión de PN 10 y PN16, según diámetro. Al estar en contacto con el agua, PLAST está conforme a las normas internacionales donde son aplicables y no contiene aditivos tóxicos.

El material PLAST está íntegramente fabricado en PP-B lo que le confiere unas características hidráulicas y mecánicas muy superiores a otras generaciones de PP ha superado las pruebas y ensayos necesarios para poder utilizar estos accesorios en la canalización de redes potables de todo tipo. Estas pruebas están basadas en la norma ISO 17885.

Algunos ejemplos de tests/ensayos superados son (\*):

De material / Valor MRS - ISO 9080 - ISO12162 – ISO1167  
Resistencia presión interna - ISO12092  
Presión interna con curvatura - ISO3503  
Resistencia a la tracción - ISO3051  
Estanqueidad bajo vacío interior - ISO3459  
Prueba de presión a largo plazo - ISO1167

(\*). Pueden consultar nuestro Dossier Técnico donde comprobarán los resultados de las pruebas descritas.

## Applications / Aplicaciones

### Pipelines / Tuberías

High, medium and low density polyethylene pipes  
PE40, PE50, PE80, PE100. / Tuberías de polietileno de  
alta, media o baja densidad PE40, PE50, PE80, PE100.

### Working conditions / Condiciones de trabajo

Maximum temperature: 80 ° C.

Nominal pressure - 16 Atm (PN16) at 20 ° C to Ø63  
- 10 Atm (PN10) at 20 ° C from Ø75

Temperatura máxima 80 ° C.

Presión nominal - 16 Atm (PN16) a 20°C hasta Ø63  
- 10 Atm (PN10) a 20°C a partir de Ø75

### Range of application / Rango de aplicación

From DN16 to DN110. Gas / BSP threads from ½ "to 4" .  
NPT threads from ½ "to 4" .

Drinking water systems, any kind of irrigation systems,  
fertilizing included, gardening, agriculture, canalization  
for alimentary fluids (wine, beer, beverage, ),  
wastewater treatment, mining, swimming pools with  
fresh or sea water, industry, telecommunications, ...

Desde DN16 a DN110. Roscas Gas/BSP desde ½ " hasta  
4" . Roscas NPT desde ½ " hasta 4" .

Acometidas de agua potable, tomas de abonado,  
instalaciones de riego, jardinería, agricultura, canalizaciones  
de uso alimentario (vino, cerveza, bebidas, ...) depuración  
de aguas, minería, piscinas de agua dulce o salada,  
industria, telecomunicaciones, etc.

## Shapes / Figuras

- **Coupling:** Equal, slip, reducing, female thread, male thread.
- **Elbows:** Equal, reducing, female thread, male thread.
- **Tee:** Equal, reducing, female thread, male thread.
- **End Cap:** Equal.
- **Adapter:** Female and male
- **Specials:** Wall support, 90° Tee male/female threaded offtake, flange adapter.
- **Ball valves:** PE-PE connection, PE- thread BSP connection (female or male), PE- thread BSP compression (female or male).
- **Check valve:**
  - PE-PE connection
  - PE-PP/PVC thread (female or male) connection
  - PE-PP/PVC female to glue
  - Uniblock PE-PP/PVC thread (female or male)

- **Manguitos:** Igual, de reparación, reducido, rosca hembra, rosca macho.
- **Codos:** Igual, reducido, rosca hembra, rosca macho.
- **TES:** Igual, reducida, rosca hembra, rosca macho.
- **Tapón:** Igual.
- **Enlace:** Rosca hembra y rosca macho.
- **Especiales:** Codo grifo, te 90° derivación. (hembra o macho), enlace brida.
- **Válvulas bola:** Conexión PE-PE, conexión PE-rosca BSP / NPT (hembra o macho).
- **Válvulas Anti-retorno:**
  - Conexión PE-PE
  - Conexión PE-PP/PVC rosca (hembra o macho)
  - Conexión PE-PP/PVC hembra encolar
  - Uniblock PE-PP/PVC rosca (hembra o macho)



## Materials / Materiales

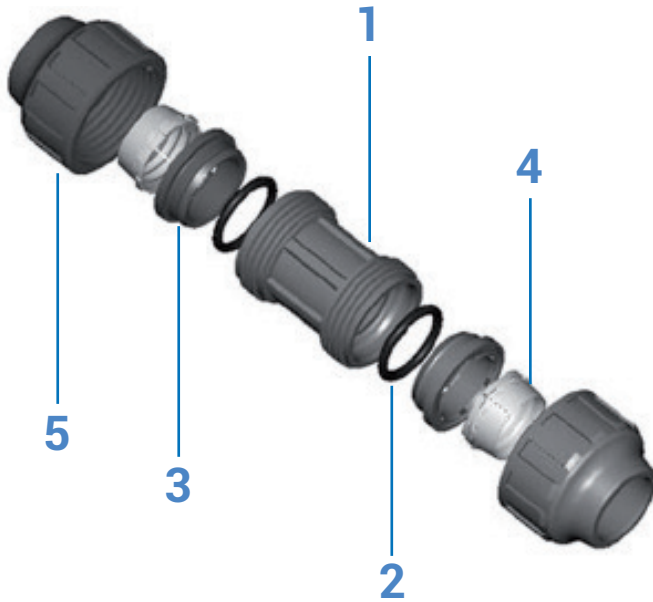

**1. Body / Cuerpo :** Polypropylene / Polipropileno

**2. O ring / Juntas tóricas :** Rubber / Caucho

**3. Compression ring / Casquillo de apriete :** Polypropylene / Polipropileno

**4. Grip Ring / Bicono de agarre :** Polyacetal Resin / Resina acetálica

**5. Nut / Tuerca :** Polypropylene / Polipropileno

**INFO:** All female threaded parts are reinforced with metal ring in stainless steel. / Todas las piezas rosca hembra van reforzadas con aro metálico en acero inoxidable.

## Non toxicity / Prescripción sanitaria

STP Acuster Group manufactures special parts for water pipe conform with the international specification relating to hygiene and sanitary requirements for the transport of the potable water and alimentary fluids. The material of the Plast fitting which is in contact with the wáter conforms to relevant national standards, where applicable, and shall not contain toxic additives.

STPAcuster Group fabrica piezas especiales para la conducción de agua y fluidos alimentarios, según las leyes y las normas vigentes en los países del mercado común. El material del accesorio Plast que está en contacto con agua es conforme a las normas internacionales, donde son aplicables, y no contiene aditivos tóxicos.

## Identification, marks / Identificación, marcas

PLAST fitting's nuts carry the indelible mark of PLAST anagram, used row material (PP-B), nominal diameter (in mm or inches), nominal pressure and the corresponding ISO norm. Bodies of the fittings carry the indelible mark of: used row material, (PP-B), nominal diameter (in mm or inches), nominal pressure and in case of threaded fittings, external or internal thread type.

Las tuercas de los accesorios PLAST, llevan grabado de forma indeleble el anagrama PLAST, el material utilizado (PPB), el Diámetro Nominal (en mm. ó pulgadas), la Presión Nominal y la norma que cumple. Asimismo, los cuerpos, con otro grabado indeleble, llevan marcados: el material utilizado (PP-B), el diámetro nominal (en mm. ó pulgadas), la presión nominal y en caso de figuras con rosca, el tipo de la rosca de enlace exterior o interior.

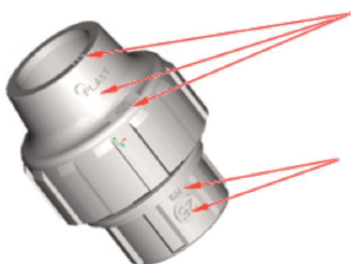

**Marks: PLAST, PP-B, Nominal Pressure, Nominal Diameter and corresponding ISO norm. /**  
Marcas: PLAST, PP-B, Presión nominal, Diámetro Nominal y norma ISO que cumple.

**Marks: PP-B, Nominal Pressure, Nominal Diameter and thread size. /**  
Marcas: PP-B, Presión Nominal, Diámetro Nominal y rosca de enlace.

Design advantages / Ventajas de diseño

HYDRAULIC SEAL / ESTANQUIDAD HIDRÁULICA

The nut (1), through the bush (5), always keeps the O-ring (4) pressed. The conical design of the bottom of the bush and the body (3) favors the pressure of the joint against the pipe, regardless of the internal pressure the reof. / La tuerca (1), a través del casquillo (5), mantiene siempre presionada la junta tórica (4). El diseño cónico del fondo del casquillo y del cuerpo (3) favorece la presión de la junta contra el tubo, independientemente de la presión interna del mismo.

MECHANICAL WORK / TRABAJO MECANICO

The special design of the fitting allows the clenching ring to go with the pipe in its natural movement due to the pull out while the clenching ring increases the resistance and holds firmly the pipe. / El especial diseño del accesorio permite al bicono acompañar al tubo en su natural desplazamiento debido a la tracción, aumentando el agarre sobre el mismo.

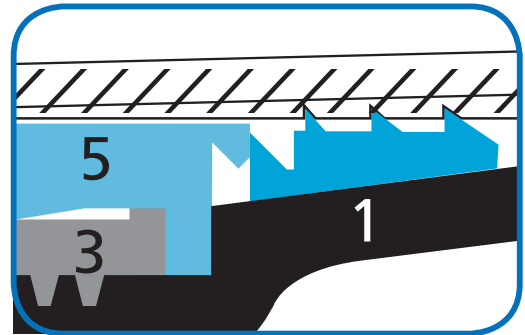
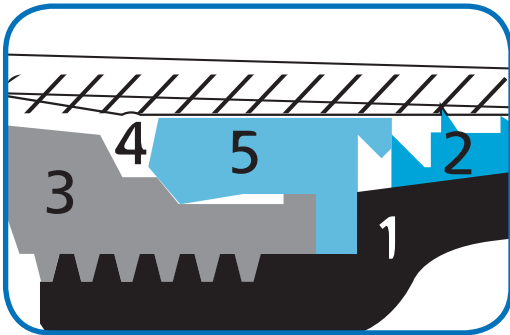
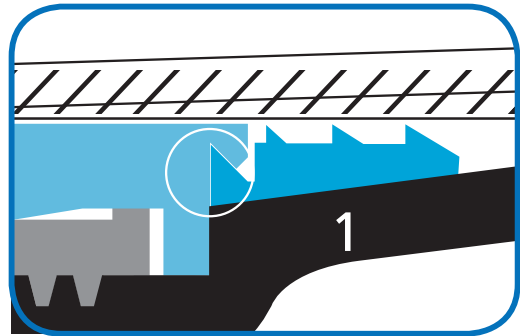
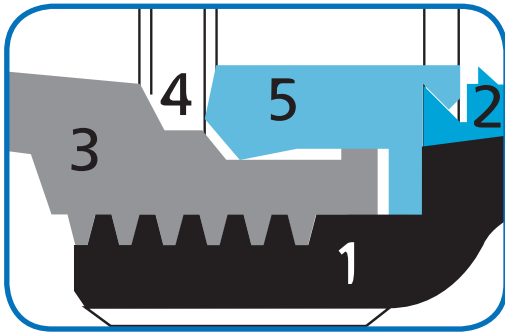

The watertightness and resistance in any type of installation is guaranteed both at low and high pressures of use of the pipe. PLAST accessories are easily installed. At the end of the assembly only a key is required to ensure its tightness and tightness. / Se garantiza la estanqueidad y resistencia en cualquier tipo de instalación tanto a bajas como a altas presiones de utilización de la tubería. Los accesorios PLAST se instalan con suma facilidad. Al final del montaje solo se necesita una llave para asegurar su cierre y estanqueidad.



**Assembly method / Sistema de montaje**

**FITTINGS AND VALVES ASSEMBLY INSTRUCTIONS.**

PLAST fittings and valves assembly is fast and easy; use of any special tools is necessary. Anyway, is recommended use of an articulated hook wrench, pretty often employed by installers. STPACUSTER GROUP has his own range of the hook wrenches, designed especially for ours fittings.

**INSTRUCCIONES DE MONTAJE DE VÁLVULAS Y ACCESORIOS.**

El montaje de las válvulas y accesorios PLAST es fácil y rápido ya que no se precisan herramientas o útiles especiales, aunque se recomienda el uso de llaves de gancho articulado, elementos muy usados por los instaladores.

**FITTINGS AND VALVES ASSEMBLY FOR PIPES FROM Ø16 UP TO Ø32**

The assembly of the small diameters fittings PLAST, sizes from Ø16 to Ø32, paying attention to the characteristic push-fitting system, should be provided as follows:

- 1) Measure the length from the internal stop of the fitting body to the nut top completely threaded. Mark the length on the pipe.
- 2) Release (unscrew) the nut near 2 full turns and insert the pipe till marked on it sign, enters into the nut.

**MONTAJE DE ACCESORIOS Y VÁLVULAS PARA TUBOS DE Ø16 A Ø32**

Teniendo en cuenta el característico sistema "entra fácil" de los accesorios PLAST, para las medidas desde Ø16 a Ø32, se deberá realizar el montaje de la siguiente manera:

- 1) Tomar la medida (con un utensilio adecuado) desde el fondo-tope del cuerpo del accesorio hasta la tuerca completamente roscada. Marcar la medida en el tubo.
- 2) Aflojar (desenroscar) la tuerca unas 2 vueltas y colocar el tubo hasta que la marca hecha entre por la tuerca.

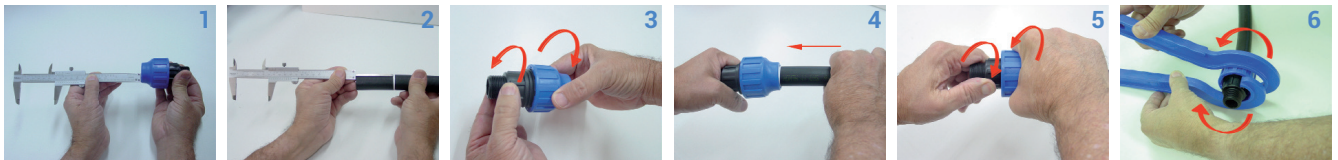

**Note:** is recommended, as for any installation, apply a dummy pressure (for example: 5 Bars) into the pipeline, abort and tighten again, before employing the final working pressure.

**Nota:** se recomienda, como en cualquier instalación, dar una primera presión (ejemplo: 5 Bares) al conjunto, quitarla y reapretar, antes de dar la presión de uso definitivo.

**FITTINGS AND VALVES ASSEMBLY FOR PIPES FROM Ø40 TO Ø50**

- 1) Disassembly the fitting separating all his components.
- 2) Clean all burrs of the pipe that can be stuck onto and place the nut, the compression ring and o-ring inside the fitting.
- 3) Measure the length from the internal stop of the fitting body to the nut top completely threaded. Mark the length on the pipe.
- 4) Insert the pipe until the internal stop of the fitting body. Bring closer (to the body) the o-ring and the compression ring, as much as possible. Screw the nut using 2 wrenches (one for the body and one for the nut).
- 5) Unscrew the nut and remove it towards the pipe. Placing the grip ring be sure that he's as close as possible to the compression ring. Again, screw the nut with 2 wrenches.



Note: is recommended, as for any installation, apply a dummy pressure (for example: 5 Bars) into the pipeline, abort and tighten again, before employing the final working pressure.

**MONTAJE DE ACCESORIOS Y VÁLVULAS PARA TUBOS DE Ø40 A Ø50**

- 1) Desmontar el accesorio que separa todos sus componentes.
- 2) Limpiar todas las rebabas de la tubería que puedan pegarse y coloque la tuerca, el anillo de compresión y el anillo tórico dentro de la conexión.
- 3) Medir la longitud desde el tope interno del cuerpo del accesorio hasta la parte superior de la tuerca completamente roscada. Marcar la longitud en el tubo.
- 4) Insertar el tubo hasta el tope interno del cuerpo del accesorio. Acercar el anillo tórico y el anillo de compresión, tanto como sea posible. Enroscar la tuerca con 2 llaves (una para el cuerpo y otra para la tuerca).
- 5) Desenroscar la tuerca y extraerla hacia el tubo. Al colocar el anillo de agarre, asegurarse de estar lo más cerca posible del anillo de compresión. De nuevo, atornillar la tuerca con 2 llaves.

Nota: se recomienda, como para cualquier instalación, aplicar una primera presión (por ejemplo: 5 bares) en la tubería, abortar y apretar de nuevo, antes de emplear la presión de trabajo final.

**FITTINGS AND VALVES ASSEMBLY FOR PIPES FROM Ø63 TO Ø110**

- 1) Measure the length from the internal stop of the fitting body to the nut top completely threaded. Mark the length on the pipe.
- 2) Make the bevel at the end of the pipe where introducing the fitting.
- 3) Release (unscrew) the nut near 2 full turns and place the pipe till marked on it sign, enters into the nut.
- 4) Tighten (screw) the nut with a hand. Using two wrenches ensure full tightness of the fitting (clamping the nut and the body).

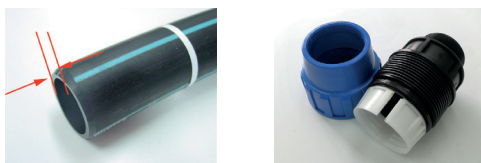

Note: is recommended, as for any installation, apply a dummy pressure (for example: 5 Bars) into the pipeline, abort and tighten again, before employing the final working pressure.

**MONTAJE DE ACCESORIOS Y VÁLVULAS PARA TUBOS DE Ø63 A Ø110**

- 1) Medir la longitud desde el tope interno del cuerpo de ajuste hasta la parte superior de la tuerca completamente roscada. Marcar la longitud en el tubo.
- 2) Hacer el bisel en el extremo de la tubería donde introducir el accesorio.
- 3) Soltar (desenroscar) la tuerca 2 vueltas completas y colocar la tubería hasta que la marca hecha en el tubo entre en la tuerca.
- 4) Apretar (atornillar) la tuerca con una mano. Utilizar dos llaves para asegurar la estanqueidad total del accesorio (sujeción de la tuerca y del cuerpo).



Nota: se recomienda, como para cualquier instalación, aplicar una primera presión (por ejemplo: 5 Bares) en la tubería, abortar y apretar de nuevo, antes de emplear la presión de trabajo final.

Plast Fittings / Accesorios Plast

Mesured in mm / Medidas en mm

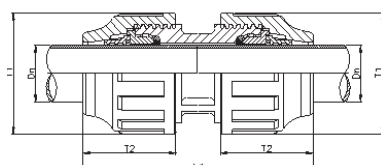

SLIP COUPLING /  
MANGUITO REPARACIÓN

| CODE      | DN  | L1    | T1    | T2    |
|-----------|-----|-------|-------|-------|
| ST725050  | 50  | 189   | 94    | 70    |
| ST725 063 | 63  | 216   | 117   | 86    |
| ST725075  | 75  | 265,5 | 126   | 108   |
| ST725090  | 90  | 288   | 146   | 117,5 |
| ST725110  | 110 | 353   | 176,5 | 139   |

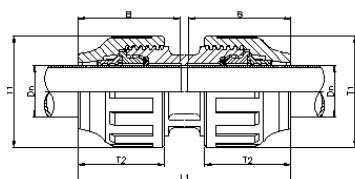

COUPLING /  
MANGUITO IGUAL

| CODE     | DN  | L1    | T1    | T2    | B     |
|----------|-----|-------|-------|-------|-------|
| ST701016 | 16  | 106,1 | 49    | 40,2  | 51,3  |
| ST701020 | 20  | 106,1 | 49    | 40,2  | 51,3  |
| ST701025 | 25  | 118   | 54    | 46    | 57    |
| ST701032 | 32  | 127,5 | 64,5  | 49    | 61,5  |
| ST701040 | 40  | 159   | 80    | 58    | 77    |
| ST701050 | 50  | 189   | 94    | 70    | 92    |
| ST701053 | 63  | 203   | 117   | 86    | 98,5  |
| ST701075 | 75  | 265,5 | 126   | 108   | 129   |
| ST701090 | 90  | 288   | 146   | 117,7 | 142   |
| ST701110 | 110 | 353   | 176,5 | 139   | 172,5 |

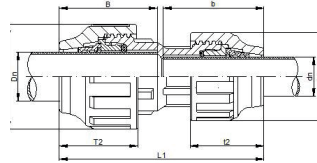

**REDUCING COUPLING /  
MANGUITO REDUCIDO**

| CODE     | DN  | dn | L1    | T1    | T2    | t1   | t2    | B    | b    |
|----------|-----|----|-------|-------|-------|------|-------|------|------|
| ST702020 | 20  | 16 | 105   | 47    | 40,2  | 47   | 40,2  | 51,5 | 52,2 |
| ST702024 | 25  | 16 | 112   | 54    | 46    | 47   | 40,2  | 57,2 | 51   |
| ST702025 | 25  | 20 | 112   | 54    | 46    | 47   | 40,2  | 57,2 | 51   |
| ST702031 | 32  | 20 | 115   | 64,5  | 49    | 47   | 40,2  | 60   | 54,6 |
| ST702032 | 32  | 25 | 121   | 64,5  | 49    | 54   | 46    | 60,5 | 57   |
| ST702039 | 40  | 25 | 137   | 80    | 58    | 54   | 46    | 75,5 | 57   |
| ST702040 | 40  | 32 | 147   | 80    | 58    | 64,5 | 49    | 82   | 60,5 |
| ST702049 | 50  | 32 | 155,5 | 94    | 70    | 64,5 | 49    | 91   | 60,5 |
| ST702050 | 50  | 40 | 172   | 94    | 70    | 80   | 58    | 92,5 | 75,5 |
| ST702062 | 63  | 40 | 193   | 117   | 86    | 80   | 58    | 194  | 78   |
| ST702063 | 63  | 50 | 199   | 117   | 86    | 94   | 70    | 97,5 | 83   |
| ST702075 | 75  | 63 | 249   | 126   | 108   | 117  | 86    | 135  | 108  |
| ST702090 | 90  | 75 | 263   | 146   | 117,5 | 126  | 108   | 148  | 138  |
| ST702110 | 110 | 90 | 335   | 176,5 | 139   | 146  | 117,5 | 180  | 158  |

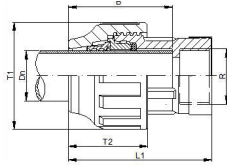

FEMALE ADAPTER /  
ENLACE ROSCA HEMBRA

| CODE     | Dn  | R      | L1    | T1    | T2    | b    |
|----------|-----|--------|-------|-------|-------|------|
| ST703016 | 16  | 1/2"   | 78    | 49    | 40,2  | 54   |
| ST703017 | 16  | 3/4"   | 78    | 49    | 40,2  | 54   |
| ST703020 | 20  | 1/2"   | 79,2  | 49    | 40,2  | 57,8 |
| ST703022 | 20  | 3/4"   | 79,2  | 49    | 40,2  | 57,8 |
| ST703024 | 25  | 1/2"   | 80    | 54    | 46    | 61,5 |
| ST703025 | 25  | 3/4"   | 80    | 54    | 46    | 61,5 |
| ST703027 | 25  | 1"     | 83,1  | 54    | 46    | 58,5 |
| ST703030 | 32  | 1/2"   | 89    | 64,5  | 49    | 64   |
| ST703031 | 32  | 3/4"   | 89    | 64,5  | 49    | 67   |
| ST703032 | 32  | 1"     | 89    | 64,5  | 49    | 65   |
| ST703033 | 32  | 1 1/4" | 94    | 64,5  | 49    | 70   |
| ST703039 | 40  | 1"     | 106   | 80    | 58    | 79   |
| ST703040 | 40  | 1 1/4" | 106   | 80    | 58    | 79   |
| ST703041 | 40  | 1 1/2" | 106   | 80    | 58    | 79   |
| ST703050 | 50  | 1 1/2" | 121,5 | 94    | 70    | 94,5 |
| ST703063 | 63  | 2"     | 136   | 117   | 86    | 100  |
| ST703074 | 75  | 2"     | 169   | 126   | 108   | 132  |
| ST703075 | 75  | 2 1/2" | 169   | 126   | 108   | 132  |
| ST703090 | 90  | 3"     | 184   | 146   | 117,7 | 146  |
| ST703110 | 110 | 4"     | 219   | 176,5 | 139   | 176  |

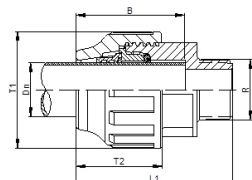

MALE ADAPTER /  
ENLACE ROSCA MACHO

| CODE     | Dn  | R      | L1     | T1    | T2    | b      |
|----------|-----|--------|--------|-------|-------|--------|
| ST704016 | 16  | 1/2"   | 71     | 49    | 40,2  | 50,2   |
| ST704017 | 16  | 3/4"   | 71,5   | 49    | 40,2  | 50,5   |
| ST704020 | 20  | 1/2"   | 74     | 49    | 40,2  | 52     |
| ST704021 | 20  | 3/4"   | 72,5   | 49    | 40,2  | 52,5   |
| ST704024 | 25  | 1/2"   | 79     | 54    | 46    | 57,5   |
| ST704025 | 25  | 3/4"   | 82,5   | 54    | 46    | 59     |
| ST704026 | 25  | 1"     | 83     | 54    | 46    | 59     |
| ST704031 | 32  | 3/4"   | 84     | 64,5  | 49    | 61,5   |
| ST704032 | 32  | 1"     | 88     | 64,5  | 49    | 62     |
| ST704033 | 32  | 1 1/4" | 87,5   | 64,5  | 49    | 61,5   |
| ST704038 | 40  | 3/4"   | 106    | 80    | 58    | 76,5   |
| ST704039 | 40  | 1"     | 105    | 80    | 58    | 71     |
| ST704040 | 40  | 1 1/4" | 104,5  | 80    | 58    | 76     |
| ST704041 | 40  | 1 1/2" | 105    | 80    | 58    | 75     |
| ST704049 | 50  | 1 1/4" | 118    | 94    | 70    | 91,5   |
| ST704050 | 50  | 1 1/2" | 121    | 94    | 70    | 92,1   |
| ST704051 | 50  | 2"     | 122    | 94    | 70    | 92     |
| ST704062 | 63  | 1 1/2" | 137    | 117   | 86    | 102,5  |
| ST704063 | 63  | 2"     | 143,25 | 117   | 86    | 110,25 |
| ST704064 | 63  | 2 1/2" | 137,5  | 117   | 86    | 107,5  |
| ST704074 | 75  | 2"     | 180,5  | 126   | 108   | 141,5  |
| ST704075 | 75  | 2 1/2" | 184    | 126   | 108   | 143,5  |
| ST704076 | 75  | 3"     | 182    | 126   | 108   | 141,5  |
| ST704090 | 90  | 3"     | 200    | 146   | 117,5 | 157,5  |
| ST704110 | 110 | 4"     | 230,5  | 176,5 | 139   | 176    |



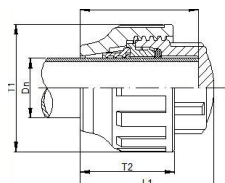

END CAP /  
TAPÓN

| CODE     | DN  | L1    | T1    | T2    | b     |
|----------|-----|-------|-------|-------|-------|
| ST705016 | 16  | 55,5  | 47    | 40,2  | 50,5  |
| ST705020 | 20  | 56,5  |       |       | 50,5  |
| ST705025 | 25  | 62,5  | 54    | 46    | 56    |
| ST705032 | 32  | 69    | 64,5  | 49    | 60,5  |
| ST705040 | 40  | 86    | 80    | 58    | 76    |
| ST705050 | 50  | 100,6 | 94    | 70    | 91    |
| ST705063 | 63  | 118   | 117   | 86    | 107,5 |
| ST705075 | 75  | 158,5 | 126   | 108   | 142   |
| ST705090 | 90  | 171   | 146   | 117,5 | 156,5 |
| ST705110 | 110 | 195,5 | 176,5 | 139   | 181   |

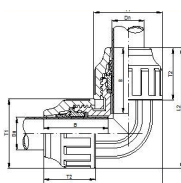

90° ELBOW /  
CODO IGUAL

| CODE     | DN  | L1    | L2    | T1    | T2    | b     |
|----------|-----|-------|-------|-------|-------|-------|
| ST706016 | 16  | 90    | 90    | 49    | 40,2  | 53    |
| ST706020 | 20  | 90    | 90    |       |       | 53    |
| ST706025 | 25  | 102   | 102   | 54    | 46    | 59    |
| ST706032 | 32  | 111,5 | 111,5 | 64,5  | 49    | 61    |
| ST706040 | 40  | 138,5 | 138,5 | 80    | 58    | 76    |
| ST706050 | 50  | 166   | 166   | 94    | 70    | 91    |
| ST706063 | 63  | 197   | 197   | 117   | 86    | 105,5 |
| ST706075 | 75  | 235   | 235   | 126   | 108   | 123   |
| ST706090 | 90  | 267   | 267   | 146   | 117,5 | 145   |
| ST706110 | 110 | 322   | 322   | 176,5 | 139   | 175,5 |

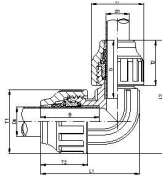

**90° REDUCING ELBOW /**  
**CODO REDUCIDO**

| CODE     | Dn | dn | L1   | L2   | T1   | T2 | B  | t1 | t2   | b  |
|----------|----|----|------|------|------|----|----|----|------|----|
| ST726024 | 25 | 16 | 97   | 99   | 54   | 46 | 59 | 49 | 40,2 | 52 |
| ST726025 | 25 | 20 | 97,5 | 99,5 | 54   | 46 | 59 | 49 | 40,2 | 53 |
| ST726032 | 32 | 25 | 107  | 115  | 64,5 | 49 | 61 | 54 | 46   | 59 |

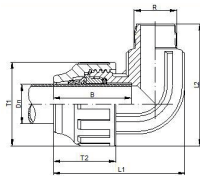

**90° MALE ELBOW /**  
**CODO MACHO**

| CODE     | DN | R      | L1    | L2   | T1   | T2   | b     |
|----------|----|--------|-------|------|------|------|-------|
| ST707016 | 16 | 1/2"   | 80,5  | 70,5 | 49   | 40,2 | 51    |
| ST707020 | 20 | 1/2"   | 82    | 67,5 | 49   | 40,2 | 53    |
| ST707021 | 20 | 3/4"   | 82,5  | 67   | 49   | 40,2 | 53    |
| ST707024 | 25 | 1/2"   | 92    | 79   | 54   | 46   | 58,5  |
| ST707025 | 25 | 3/4"   | 93    | 74,5 | 54   | 46   | 58,5  |
| ST707026 | 25 | 1"     | 92    | 81   | 54   | 46   | 59    |
| ST707031 | 32 | 3/4"   | 105,5 | 83,5 | 64,5 | 49   | 60,5  |
| ST707032 | 32 | 1"     | 102,5 | 92,5 | 64,5 | 49   | 61    |
| ST707033 | 32 | 1 1/4" | 104   | 90   | 64,5 | 50   | 60,5  |
| ST707039 | 40 | 1"     | 125,5 | 105  | 80   | 58   | 75,5  |
| ST707040 | 40 | 1 1/4" | 127   | 106  | 80   | 58   | 76    |
| ST707050 | 50 | 1 1/2" | 153   | 128  | 94   | 70   | 91,5  |
| ST707063 | 63 | 2"     | 176   | 141  | 117  | 86   | 100,5 |

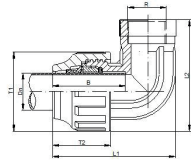

**90° FEMALE ELBOW /**  
**CODO HEMBRA**

| CODE     | DN  | R      | L1    | L2    | T1    | T2    | b     |
|----------|-----|--------|-------|-------|-------|-------|-------|
| ST708016 | 16  | 1/2"   | 80,5  | 66    | 49    | 40,2  | 50,5  |
| ST708020 | 20  | 1/2"   | 82    | 66    | 49    | 40,2  | 51,5  |
| ST708021 | 20  | 3/4"   | 85,5  | 68    | 49    | 40,2  | 54    |
| ST708024 | 25  | 1/2"   | 92,5  | 67    | 54    | 46    | 59    |
| ST708025 | 25  | 3/4"   | 93    | 73,5  | 54    | 46    | 57,5  |
| ST708026 | 25  | 1"     | 98    | 75,5  | 54    | 46    | 59    |
| ST708029 | 32  | 1/2"   | 102,5 | 91    | 64,5  | 49    | 61,5  |
| ST708031 | 32  | 3/4"   | 102,5 | 91    | 64,5  | 49    | 61,5  |
| ST708032 | 32  | 1"     | 103   | 91    | 64,5  | 49    | 61,5  |
| ST708033 | 32  | 1 1/4" | 102,5 | 91    | 64,5  | 49    | 61,5  |
| ST708039 | 40  | 1"     | 127   | 103   | 80    | 58    | 76,5  |
| ST708040 | 40  | 1 1/4" | 127,5 | 103   | 80    | 58    | 76,5  |
| ST708050 | 50  | 1 1/2" | 153   | 122   | 94    | 70    | 91,5  |
| ST708063 | 63  | 2"     | 175,5 | 142   | 117   | 86    | 100,5 |
| ST708075 | 75  | 2 1/2" | 224,5 | 146,5 | 126   | 108   | 124   |
| ST708090 | 90  | 3"     | 261   | 176,5 | 146   | 117,5 | 145   |
| ST708110 | 110 | 4"     | 313   | 208   | 176,5 | 139   | 175   |

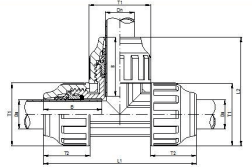

**90° TEE /  
TE IGUAL**

| CODE     | Dn  | L1    | L2    | T1    | T2    | B     |
|----------|-----|-------|-------|-------|-------|-------|
| ST706016 | 16  | 90    | 90    | 49    | 40,2  | 53    |
| ST706020 | 20  | 90    | 90    |       |       | 53    |
| ST706025 | 25  | 102   | 102   | 54    | 46    | 59    |
| ST706032 | 32  | 111,5 | 111,5 | 64,5  | 49    | 61    |
| ST706040 | 40  | 138,5 | 138,5 | 80    | 58    | 76    |
| ST706050 | 50  | 166   | 166   | 94    | 70    | 91    |
| ST706063 | 63  | 197   | 197   | 117   | 86    | 105,5 |
| ST706075 | 75  | 235   | 235   | 126   | 108   | 123   |
| ST706090 | 90  | 267   | 267   | 146   | 117,5 | 145   |
| ST706110 | 110 | 322   | 322   | 176,5 | 139   | 175,5 |

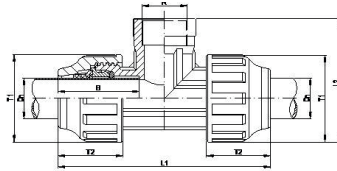

**90° FEMALE TEE /  
TE HEMBRA**

| CODE     | DN  | R      | L1    | L2    | T1    | T2    | b     |
|----------|-----|--------|-------|-------|-------|-------|-------|
| ST710016 | 16  | 1/2"   | 129   | 66    | 49    | 40,2  | 52    |
| ST710020 | 20  | 1/2"   | 132   | 66    | 49    | 40,2  | 51    |
| ST710021 | 20  | 3/4"   | 132   | 69    | 49    | 40,2  | 53    |
| ST710024 | 25  | 1/2"   | 150   | 66,5  | 54    | 46    | 59    |
| ST710025 | 25  | 3/4"   | 148   | 74    | 54    | 46    | 57    |
| ST710026 | 25  | 1"     | 147   | 76    | 54    | 46    | 59    |
| ST710029 | 32  | 1/2"   | 155   | 91    | 64,5  | 49    | 61    |
| ST710031 | 32  | 3/4"   | 160   | 91    | 64,5  | 49    | 61    |
| ST710032 | 32  | 1"     | 160   | 91    | 64,5  | 49    | 61    |
| ST710033 | 32  | 1 1/4" | 162   | 89,5  | 64,5  | 49    | 61    |
| ST710039 | 40  | 1"     | 199   | 102,5 | 80    | 58    | 76,5  |
| ST710040 | 40  | 1 1/4" | 198,5 | 102   | 80    | 58    | 76    |
| ST710050 | 50  | 1 1/2" | 240,5 | 122,5 | 94    | 70    | 91,5  |
| ST710062 | 63  | 1 1/2" | 269   | 143,5 | 117   | 86    | 100   |
| ST710063 | 63  | 2"     | 269   | 143,5 | 117   | 86    | 100   |
| ST710075 | 75  | 2 1/2" | 345   | 148   | 126   | 108   | 122,5 |
| ST710090 | 90  | 3"     | 398   | 180   | 146   | 117,5 | 144,5 |
| ST710110 | 110 | 4"     | 466   | 209   | 176,5 | 139   | 175,5 |

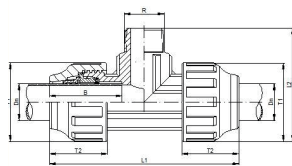

90° MALE TEE /  
TE MACHO

| CODE     | DN | R      | L1    | L2    | T1   | T2   | b    |
|----------|----|--------|-------|-------|------|------|------|
| ST711016 | 16 | 1/2"   | 129,5 | 71    | 49   | 40,2 | 52   |
| ST711020 | 20 | 1/2"   | 132   | 69,5  | 49   | 40,2 | 53   |
| ST711021 | 20 | 3/4"   | 132   | 72    | 49   | 40,2 | 53   |
| ST711024 | 25 | 1/2"   | 147,5 | 72    | 54   | 54   | 59   |
| ST711025 | 25 | 3/4"   | 147,5 | 74,5  | 54   | 54   | 59   |
| ST711026 | 25 | 1"     | 147,5 | 80    | 54   | 54   | 59   |
| ST711031 | 32 | 3/4"   | 160   | 87,5  | 64,5 | 49   | 61   |
| ST711032 | 32 | 1"     | 160   | 93    | 64,5 | 49   | 61,5 |
| ST711033 | 32 | 1 1/4" | 160   | 93    | 64,5 | 49   | 61   |
| ST711039 | 40 | 1"     | 198,5 | 102,5 | 80   | 58   | 76   |
| ST711040 | 40 | 1 1/4" | 198   | 106   | 80   | 58   | 76   |
| ST711050 | 50 | 1 1/2" | 241   | 123,5 | 94   | 70   | 91,5 |
| ST711063 | 63 | 2"     | 269   | 144   | 117  | 86   | 100  |

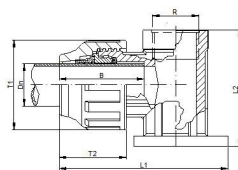

WALL SUPPORT /  
CODO GRIFO

| CODE     | Dn | R    | L1   | L2 | T1 | T2   | B    |
|----------|----|------|------|----|----|------|------|
| ST712016 | 16 | 1/2" | 90   | 63 | 49 | 40,2 | 50   |
| ST712020 | 20 | 1/2" | 90,5 | 63 | 49 | 40,2 | 50,5 |
| ST712025 | 25 | 3/4" | 104  | 66 | 54 | 46   | 59   |



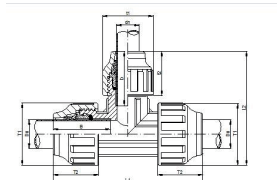

90° REDUCING TEE /  
TE REDUCIDA

| CODE     | Dn | dn | L1    | L2    | T1   | T2   | B    | t1   | t2   | b    |
|----------|----|----|-------|-------|------|------|------|------|------|------|
| ST713020 | 20 | 16 | 132   | 88    | 47   | 40,2 | 53   | 49   | 40,2 | 53   |
| ST713024 | 25 | 16 | 147   | 99,5  | 54   | 46   | 58,5 | 49   | 40,2 | 51,5 |
| ST713025 | 25 | 20 | 147   | 101   | 54   | 54   | 59   | 49   | 40,2 | 53   |
| ST713032 | 32 | 25 | 159   | 120,5 | 64,5 | 49   | 61   | 54   | 46   | 59   |
| ST713040 | 40 | 32 | 198,5 | 140   | 80   | 58   | 76   | 64,5 | 49   | 61,5 |
| ST713049 | 50 | 32 | 240   | 148,5 | 94   | 70   | 91   | 64,5 | 49   | 64   |
| ST713050 | 50 | 40 | 240,5 | 165   | 94   | 70   | 92   | 80   | 58   | 75,5 |
| ST713063 | 63 | 50 | 268,5 | 188,5 | 117  | 85,5 | 99,5 | 94   | 70   | 90   |

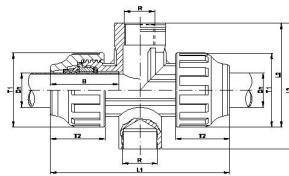

90° TEE DOUBLE FEMALE OFFTAKE /  
TE 90° DERIVACIÓN DOBLE HEMBRA

| CODE     | Dn | R    | L1    | L2   | L3   | T1   | T2 | B  |
|----------|----|------|-------|------|------|------|----|----|
| ST710030 | 32 | 3/4" | 159,5 | 91,5 | 98,5 | 64,5 | 49 | 61 |

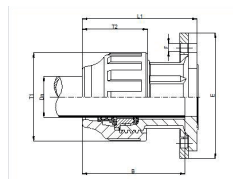

FLANGE ADAPTER /  
ENLACE BRIDA

| CODE     | Dn  | L1  | T1    | T2    | B     | E   | F    |
|----------|-----|-----|-------|-------|-------|-----|------|
| ST714050 | 50  | 116 | 94    | 70    | 103,5 | 150 | 4x18 |
| ST714063 | 63  | 133 | 117   | 86    | 119   | 165 | 4x18 |
| ST714075 | 75  | 171 | 126   | 108   | 157   | 185 | 4x18 |
| ST714090 | 90  | 182 | 146   | 117,5 | 165   | 200 | 8x18 |
| ST714110 | 110 | 208 | 176,5 | 139   | 185   | 220 | 8x18 |

\*Available in blue or black nut / Disponible en tuerca azul o negro

PP valves / Válvulas de PP

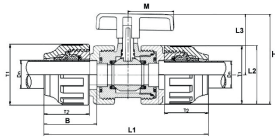

PE-PE COMPRESSION /  
CONEXIÓN PE-PE

| CODE      | Dn | L1    | L2  | L3  | H   | M  | T1   | T2   | B    |
|-----------|----|-------|-----|-----|-----|----|------|------|------|
| ST141016C | 16 | 148,4 | 47  | 45  | 69  | 35 | 47   | 40,2 | 49,2 |
| ST141020C | 20 | 148,4 | 47  | 45  | 69  | 35 | 47   | 40,2 | 49,2 |
| ST141025C | 25 | 184   | 67  | 70  | 103 | 53 | 54   | 46   | 56   |
| ST141032C | 32 | 188   | 67  | 70  | 103 | 53 | 64,5 | 49   | 59   |
| ST141040C | 40 | 232   | 93  | 92  | 139 | 64 | 80   | 58   | 70   |
| ST141050C | 50 | 260   | 93  | 92  | 139 | 64 | 94   | 70   | 84   |
| ST141063C | 63 | 335   | 113 | 105 | 162 | 73 | 117  | 86   | 112  |

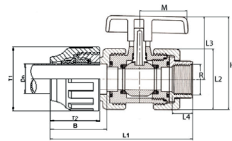

PE COMPRESSION - FEMALE BSP THREAD /  
CONEXIÓN PE - ROSCA HEMBRA BSP

| CODE       | Dn | R      | L1    | L2  | L3  | L4 | H   | M  | T1   | T2   | B    |
|------------|----|--------|-------|-----|-----|----|-----|----|------|------|------|
| ST140016CX | 16 | 1/2"   | 116,2 | 47  | 45  | 15 | 69  | 35 | 47   | 40,2 | 49,2 |
| ST140020CX | 20 | 1/2"   | 116,2 | 47  | 45  | 15 | 69  | 35 | 47   | 40,2 | 49,2 |
| ST140025CX | 25 | 3/4"   | 145,5 | 67  | 70  | 16 | 103 | 53 | 54   | 46   | 56   |
| ST140032CX | 32 | 1"     | 151,5 | 67  | 70  | 19 | 103 | 53 | 64,5 | 49   | 59   |
| ST140040CX | 40 | 1 1/4" | 189   | 93  | 92  | 21 | 139 | 64 | 80   | 58   | 70   |
| ST140050CX | 50 | 1 1/2" | 207   | 93  | 92  | 22 | 139 | 64 | 94   | 70   | 84   |
| ST140063CX | 63 | 2"     | 261   | 113 | 105 | 26 | 162 | 73 | 117  | 86   | 112  |

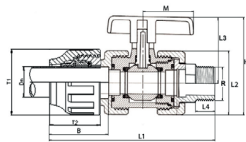

PE COMPRESSION - MALE BSP THREAD /  
COMPRESIÓN PE - ROSCA MACHO BSP

| CODE      | Dn | R      | L1    | L2  | L3  | L4   | H   | M  | T1   | T2   | B    |
|-----------|----|--------|-------|-----|-----|------|-----|----|------|------|------|
| ST142016C | 16 | 1/2"   | 132,2 | 47  | 45  | 15   | 69  | 35 | 47   | 40,2 | 49,2 |
| ST142020C | 20 | 1/2"   | 132,2 | 47  | 45  | 15   | 69  | 35 | 47   | 40,2 | 49,2 |
| ST142025C | 25 | 3/4"   | 164   | 67  | 70  | 16,5 | 103 | 53 | 54   | 46   | 56   |
| ST142032C | 32 | 1"     | 166,5 | 67  | 70  | 19   | 103 | 53 | 64,5 | 49   | 59   |
| ST142040C | 40 | 1 1/4" | 206,5 | 93  | 92  | 19   | 139 | 64 | 80   | 58   | 70   |
| ST142050C | 50 | 1 1/2" | 223,5 | 93  | 92  | 21   | 139 | 64 | 94   | 70   | 84   |
| ST142063C | 63 | 2"     | 278   | 113 | 105 | 26   | 162 | 73 | 117  | 86   | 112  |

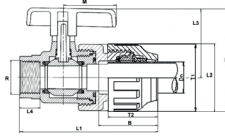

**PE COMPRESSION - FEMALE BSP THREAD /  
COMPRESIÓN PE - ROSCA HEMBRA BSP**

| CODE       | Dn | R      | L1    | L2  | L3  | L4 | H   | M  | T1   | T2   | B    |
|------------|----|--------|-------|-----|-----|----|-----|----|------|------|------|
| ST146016CF | 16 | 1/2"   | 105,2 | 47  | 45  | 15 | 69  | 35 | 47   | 40,2 | 49,2 |
| ST146020CF | 20 | 1/2"   | 105,2 | 47  | 45  | 15 | 69  | 35 | 47   | 40,2 | 49,2 |
| ST146025CF | 25 | 3/4"   | 133   | 67  | 70  | 16 | 103 | 53 | 54   | 46   | 56   |
| ST146026CF | 25 | 1"     | 133   | 67  | 70  | 19 | 103 | 53 | 54   | 46   | 56   |
| ST146032CF | 32 | 1"     | 139   | 67  | 70  | 19 | 103 | 53 | 64,5 | 49   | 59   |
| ST146040CF | 40 | 1 1/4" | 172   | 93  | 92  | 21 | 139 | 64 | 80   | 58   | 70   |
| ST146050CF | 50 | 1 1/2" | 189,5 | 93  | 92  | 22 | 139 | 64 | 94   | 70   | 84   |
| ST146063CF | 63 | 2"     | 227   | 113 | 105 | 26 | 162 | 73 | 117  | 86   | 112  |

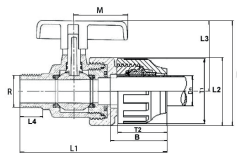

**PE COMPRESSION - MALE BSP THREAD /  
COMPRESIÓN PE - ROSCA MACHO BSP**

| CODE       | Dn | R      | L1    | L2  | L3  | L4 | H   | M  | T1   | T2   | B    |
|------------|----|--------|-------|-----|-----|----|-----|----|------|------|------|
| ST147016CM | 16 | 1/2"   | 111,2 | 47  | 45  | 15 | 69  | 35 | 47   | 40,2 | 49,2 |
| ST147020CM | 20 | 1/2"   | 111,2 | 47  | 45  | 15 | 69  | 35 | 47   | 40,2 | 49,2 |
| ST147025CM | 25 | 3/4"   | 142   | 67  | 70  | 16 | 103 | 53 | 54   | 46   | 56   |
| ST147026CM | 25 | 1"     | 142   | 67  | 70  | 19 | 103 | 53 | 54   | 46   | 56   |
| ST147032CM | 32 | 1"     | 146   | 67  | 70  | 19 | 103 | 53 | 64,5 | 49   | 59   |
| ST147040CM | 40 | 1 1/4" | 182   | 93  | 92  | 21 | 139 | 64 | 80   | 58   | 70   |
| ST147050CM | 50 | 1 1/2" | 199,5 | 93  | 92  | 22 | 139 | 64 | 94   | 70   | 84   |
| ST147063CM | 63 | 2"     | 238   | 113 | 105 | 26 | 162 | 73 | 117  | 86   | 112  |

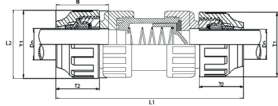

**CHECK VALVE PE-PE /  
VÁLVULA ANTI RETORNO PE-PE**

| CODE      | Dn | L1    | L2  | T1   | T2   | B    |
|-----------|----|-------|-----|------|------|------|
| ST143016C | 16 | 148,4 | 47  | 47   | 40,2 | 49,2 |
| ST143020C | 20 | 148,4 | 47  | 47   | 40,2 | 49,2 |
| ST143025C | 25 | 184   | 67  | 54   | 46   | 56   |
| ST143032C | 32 | 188   | 67  | 64,5 | 49   | 59   |
| ST143040C | 40 | 232   | 93  | 80   | 58   | 70   |
| ST143050C | 50 | 260   | 93  | 94   | 70   | 83,5 |
| ST143063C | 63 | 320   | 113 | 117  | 86   | 107  |

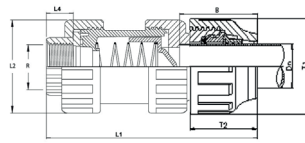

**CHECK VALVE PE-PP/PVC FEMALE THREAD /  
VÁLVULA ANTI RETORNO PE-PP/PVC ROSCA HEMBRA**

| CODE      | Dn | R      | L1    | L2  | L4 | T1   | T2   | B    |
|-----------|----|--------|-------|-----|----|------|------|------|
| ST144016C | 16 | 1/2"   | 116,2 | 47  | 15 | 47   | 40,2 | 49,2 |
| ST144020C | 20 | 1/2"   | 116,2 | 47  | 15 | 47   | 40,2 | 49,2 |
| ST144025C | 25 | 3/4"   | 145   | 67  | 16 | 54   | 46   | 56   |
| ST144032C | 32 | 1"     | 151   | 67  | 19 | 64,5 | 49   | 59   |
| ST144040C | 40 | 1 1/4" | 189   | 93  | 21 | 80   | 58   | 70   |
| ST144050C | 50 | 1 1/2" | 206,5 | 93  | 22 | 94   | 70   | 83,5 |
| ST144063C | 63 | 2"     | 251   | 113 | 26 | 117  | 86   | 107  |

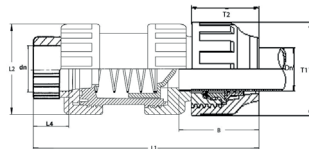

**CHECK VALVE PE-PP/PVC FEMALE TO GLUE /  
VÁLVULA ANTI RETORNO PE-PP/PVC ENCOLAR HEMBRA**

| CODE       | Dn | dn | L1    | L2  | L4 | T1   | T2   | B    |
|------------|----|----|-------|-----|----|------|------|------|
| ST144016CX | 16 | 16 | 116,2 | 47  | 15 | 47   | 40,2 | 49,2 |
| ST144020CX | 20 | 20 | 116,2 | 47  | 15 | 47   | 40,2 | 49,2 |
| ST144025CX | 25 | 25 | 145   | 67  | 16 | 54   | 46   | 56   |
| ST144032CX | 32 | 32 | 151   | 67  | 19 | 64,5 | 49   | 59   |
| ST144040CX | 40 | 40 | 189   | 93  | 21 | 80   | 58   | 70   |
| ST144050CX | 50 | 50 | 206,5 | 93  | 22 | 94   | 70   | 83,5 |
| ST144063CX | 63 | 63 | 251   | 113 | 26 | 117  | 86   | 107  |

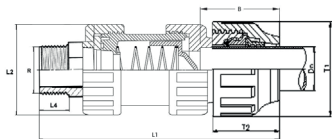

**CHECK VALVE PE-PP/PVC MALE THREAD /  
VÁLVULA ANTI RETORNO PE-PP/PVC ROSCA MACHO**

| CODE      | Dn | R      | L1    | L2  | L4   | T1   | T2   | B    |
|-----------|----|--------|-------|-----|------|------|------|------|
| ST145016C | 16 | 1/2"   | 132,2 | 47  | 15   | 47   | 40,2 | 49,2 |
| ST145020C | 20 | 1/2"   | 132,2 | 47  | 15   | 47   | 40,2 | 49,2 |
| ST145025C | 25 | 3/4"   | 163,5 | 67  | 16,5 | 54   | 46   | 56   |
| ST145032C | 32 | 1"     | 166   | 67  | 19   | 64,5 | 49   | 59   |
| ST145040C | 40 | 1 1/4" | 206,5 | 93  | 19   | 80   | 58   | 70   |
| ST145050C | 50 | 1 1/2" | 223   | 93  | 21   | 94   | 70   | 83,5 |
| ST145063C | 63 | 2"     | 268   | 113 | 26   | 117  | 86   | 107  |

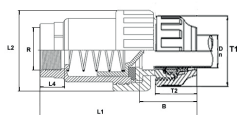

**CHECK VALVE UNIBLOCK PE-PP/PVC FEMALE THREAD /  
VÁLVULA ANTI RETORNO UNIBLOCK PE-PP/PVC  
ROSCA HEMBRA**

| CODE       | Dn | R      | L1    | L2  | L4 | T1   | T2   | B    |
|------------|----|--------|-------|-----|----|------|------|------|
| ST148016CF | 16 | 1/2"   | 105,2 | 47  | 15 | 47   | 40,2 | 49,2 |
| ST148020CF | 20 | 1/2"   | 105,2 | 47  | 15 | 47   | 40,2 | 49,2 |
| ST148025CF | 25 | 3/4"   | 133   | 67  | 16 | 54   | 46   | 56   |
| ST148032CF | 32 | 1"     | 139   | 67  | 19 | 64,5 | 49   | 59   |
| ST148040CF | 40 | 1 1/4" | 172   | 93  | 21 | 80   | 58   | 70   |
| ST148050CF | 50 | 1 1/2" | 189,5 | 93  | 22 | 94   | 70   | 83,5 |
| ST148063CF | 63 | 2"     | 227   | 113 | 26 | 117  | 86   | 107  |

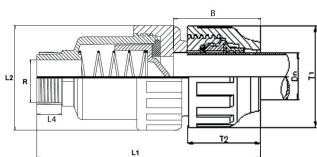

**CHECK VALVE UNIBLOCK PE-PP/PVC MALE THREAD /  
VÁLVULA ANTI RETORNO UNIBLOCK PE-PP/PVC  
ROSCA MACHO**

| CODE       | Dn | R      | L1    | L2  | L4 | T1   | T2   | B    |
|------------|----|--------|-------|-----|----|------|------|------|
| ST149016CM | 16 | 1/2"   | 111,2 | 47  | 15 | 47   | 40,2 | 49,2 |
| ST149020CM | 20 | 1/2"   | 111,2 | 47  | 15 | 47   | 40,2 | 49,2 |
| ST149025CM | 25 | 3/4"   | 142   | 67  | 16 | 54   | 46   | 56   |
| ST149032CM | 32 | 1"     | 146   | 67  | 19 | 64,5 | 49   | 59   |
| ST149040CM | 40 | 1 1/4" | 182   | 93  | 21 | 80   | 58   | 70   |
| ST149050CM | 50 | 1 1/2" | 199,5 | 93  | 22 | 94   | 70   | 83,5 |
| ST149063CM | 63 | 2"     | 238   | 113 | 26 | 117  | 86   | 107  |

\*Available in blue or black nut / Disponible en tuerca azul o negro

**Characteristics compression valves / Características válvulas de compresión**

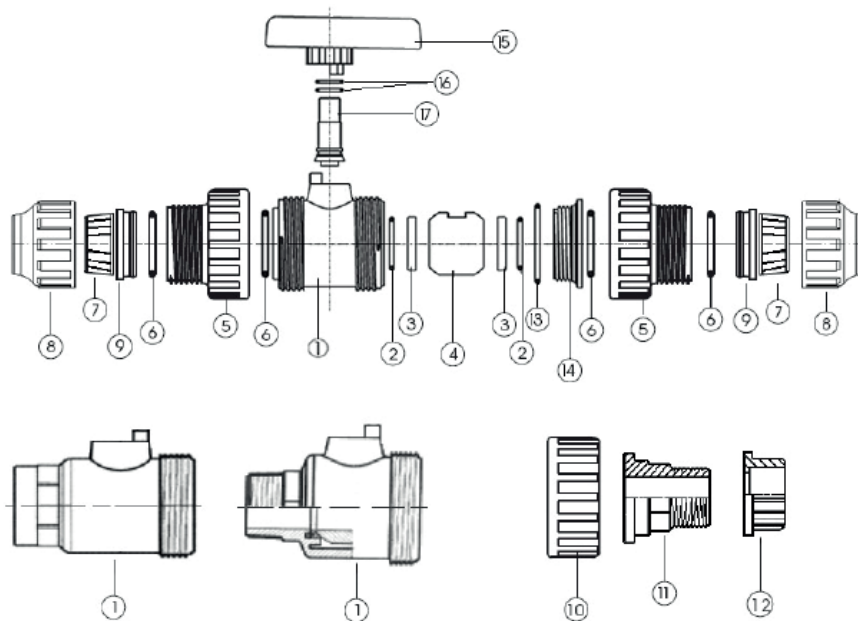

| nº | Part / Componente                      | Material         |
|----|--|------------------|
| 1  | body / cuerpo                          | pph 2150         |
| 2  | o-ring / junta                         | epdm             |
| 3  | ball backup / apoyo de bola            | tpe teflon       |
| 4  | ball / bola                            | pph 2150         |
| 5  | double nut / tuerca doble              | pph 2150         |
| 6  | o-ring / junta                         | nitrile ruber    |
| 7  | grip ring / bicono                     | polyacetal resin |
| 8  | compression nut / tuerca de compresión | polypropilene    |
| 9  | compression ring / casquillo           | polypropilene    |
| 10 | simple nut / tuerca simple             | pph 2150         |
| 11 | male adapter / rosca macho             | polypropilene    |
| 12 | female adapter / adaptador hembra      | polypropilene    |
| 13 | o-ring / junta                         | epdm             |
| 14 | threaded cap / casquillo de ajuste     | pph 2150         |
| 15 | lever / maneta                         | pph 2150         |
| 16 | o-ring / junta                         | epdm             |
| 17 | stem / eje                             | pph 2150         |

WORKING CONDITIONS: Working pressure 10 atm / CONDICIONES DE TRABAJO: Presión nominal: 10 atm



**Characteristics check compression valves / Características válvulas de compresión anti-retorno**

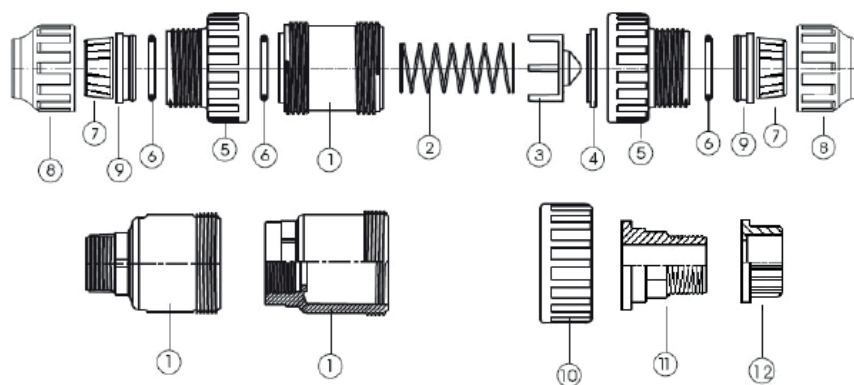

| nº | Part / Componente                      | Material         |
|----|--|------------------|
| 1  | body / cuerpo                          | pph 2150         |
| 2  | spring / muelle                        | inox steel       |
| 3  | cone / cono                            | pvc u            |
| 4  | cone o-ring / junta del cono           | epdm             |
| 5  | double nut / tuerca doble              | pph 2150         |
| 6  | o-ring / junta                         | nitrile ruber    |
| 7  | grip ring / bicono                     | polyacetal resin |
| 8  | compression nut / tuerca de compresión | polypropilene    |
| 9  | compression ring / casquillo           | polypropilene    |
| 10 | simple nut / tuerca simple             | pph 2150         |
| 11 | male adapter / rosca macho             | polypropilene    |
| 12 | female adapter / rosca hembra          | polypropilene    |

**WORKING CONDITIONS: Working pressure 10 atm. Minimum working pressure: 0,5-0,8 Bar /**  
CONDICIONES DE TRABAJO: Presión nominal: 10 atm. Presión Nominal de trabajo: 0,5-0,8 Bar